

### INSTALLATION: Direct-wire Power Adapter

An adapter has been provided so that you can wire Valentine One directly into your car's electrical system. If you are unfamiliar with automotive electrical systems, see a mechanic or car-stereo installer:

1. Valentine One works only with negative ground electrical systems. If your car is old, or is an unusual brand of import, make sure it's negative ground.
2. Select a "switched" wire, i.e., one that's off when the ignition is switched off, and has 12 volts when the ignition is switched on.
3. Position wiring-harness connector around "switched" wire and squeeze with pliers to install.
4. Plug red wire from Direct-wire Power Adapter into wiring-harness connector.
5. Make ground connection by clamping the end of the black wire under any grounded screw.
6. Plug power cord from Valentine One into the modular jack labeled "Main" on the Direct-wire Power Adapter.

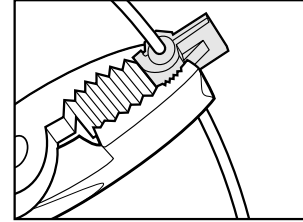

Pinch connector around power wire.

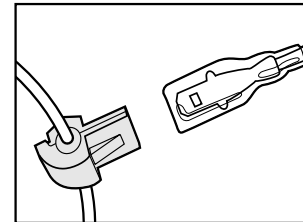

Connector plugs into red wire.

### Changing the Direct-wire Power Adapter Fuse

The fuse holder is in-line with the power wire (red) to the Adapter. Lift the fuse cover from the body of the fuse holder. A twisting motion may help, or pry gently at the parting line with a thin tool, perhaps a small screwdriver. Unplug the fuse. Replace with a 2 amp. Mini Blade fuse.

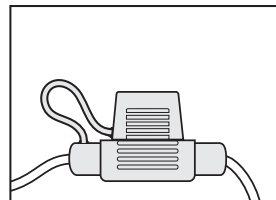
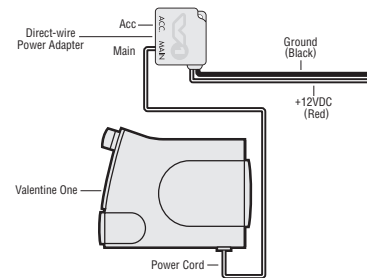

In-line fuse holder.

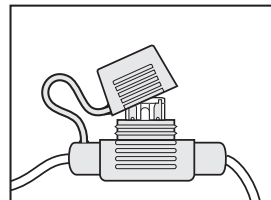

Lift cover.

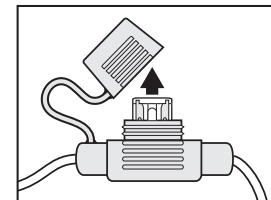

Unplug fuse.

## Lighter Adapter

### Articulated Bracket ▼

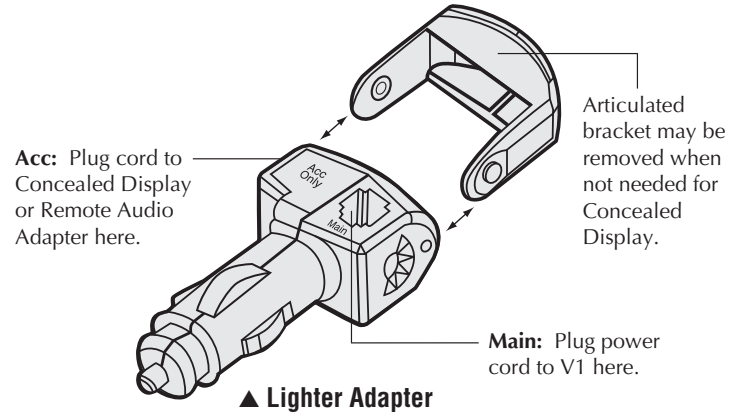

### Changing the Lighter Adapter Fuse

#### Adapters using 2-amp Mini Blade fuse

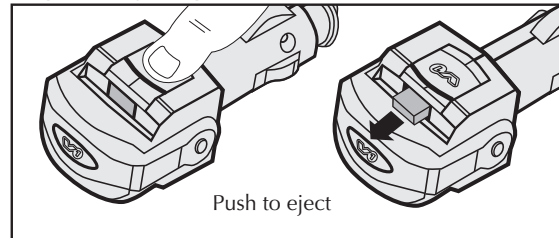

#### Adapters using 1-amp 5 mm x 20mm fuse

